

Village: Muthkur

Hobli: Hesragatta

Taluk: Yelahanka

Developed By
"SRISAI SAMRUDDHI"

(DC Converted Sites)

Residential Plan Showing in Re Sy.No: 40/2 & 40/7

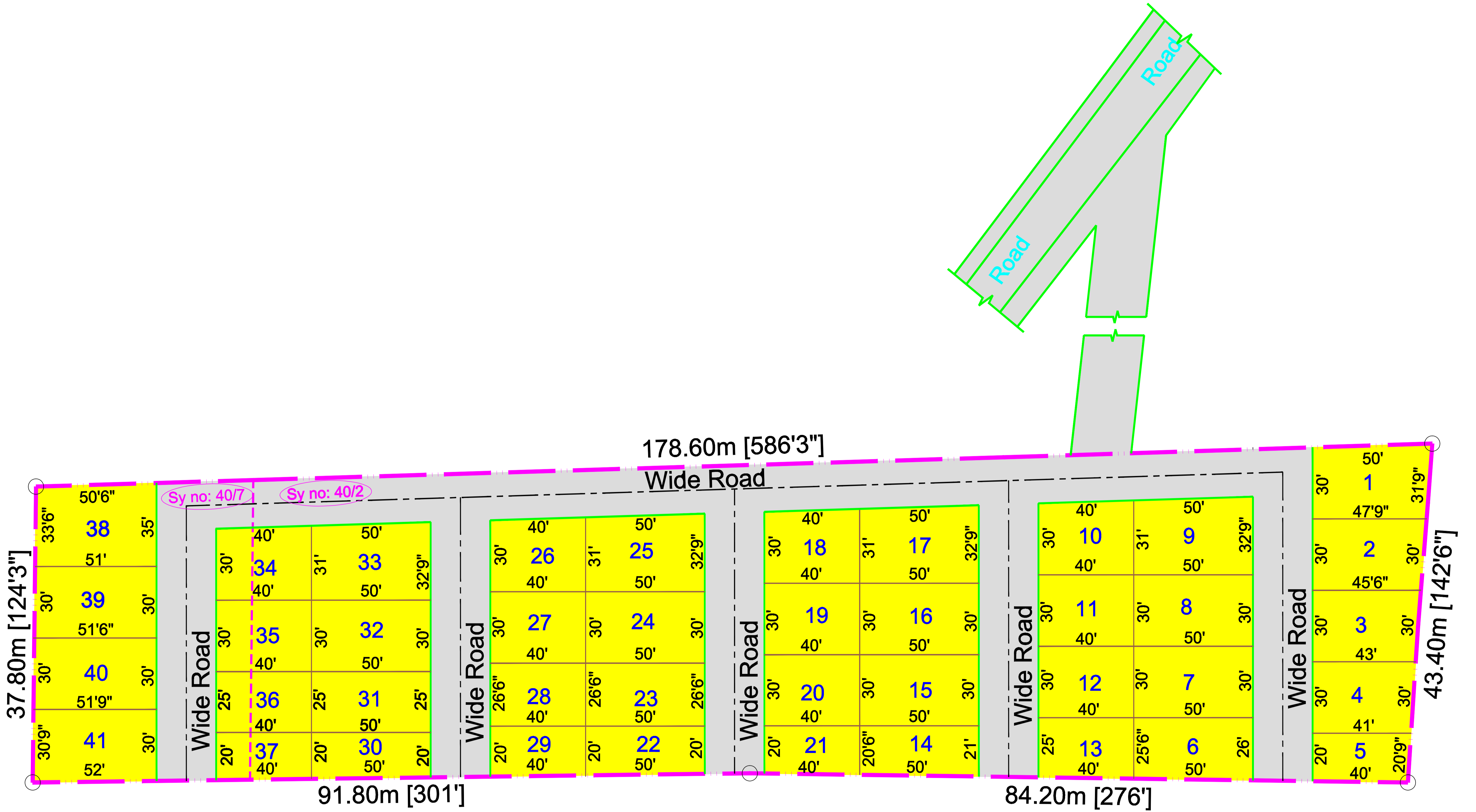
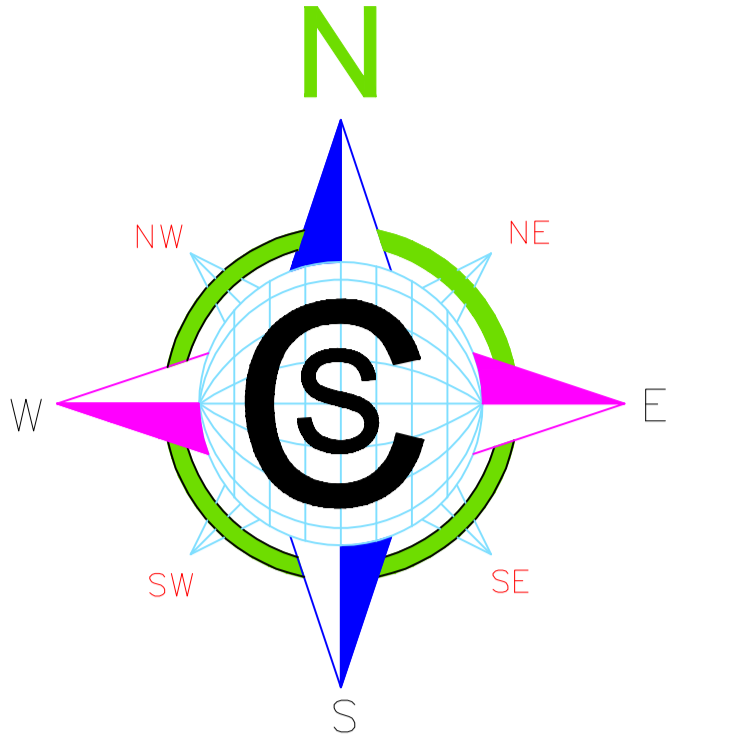

Sl no:	Site No:	Dimensions	Area (In Sqft)	no of Sites	Total Area
1	1	$[(50'+47'9'')/2 \times (31'9''+30'')/2]$	1509.00	1	1509.00
2	2	$[30' \times (47'9''+45'6'')/2]$	1398.50	1	1398.50
3	3	$[30' \times (45'6''+43'')/2]$	1327.50	1	1327.50
4	4	$[30' \times (43'+41'')/2]$	1260.00	1	1260.00
5	5	$[(41'+40'')/2 \times (20'+20'9'')/2]$	825.00	1	825.00
6	6	$[50' \times (26'+25'6'')/2]$	1287.50	1	1287.50
7	7,8,15,16 24,32,	50' X 30'	1500.00	6	9000.00
8	9,17,25,33	$[50' \times (32'9''+31'')/2]$	1593.50	4	6374.00
9	10,18,26,34	$[40' \times (31'+30'')/2]$	1220.00	4	4880.00
10	11,12,19,20 27,35	40' X 30'	1200.00	6	7200.00
11	13	$[40' \times (25'6''+25'')/2]$	1010.00	1	1010.00
12	14	$[50' \times (21'+20'6'')/2]$	1037.50	1	1037.50
13	21	$[40' \times (20'6''+20'')/2]$	810.00	1	810.00
14	22,30	50' X 20'	1000.00	2	2000.00
15	23	50' X 26'6"	1325.00	1	1325.00
16	28	40' X 26'6"	1060.00	1	1060.00
17	29,37	40' X 20'	800.00	2	1600.00
18	31	50' X 25'	1250.00	1	1250.00
19	36	40' X 25'	1000.00	1	1000.00
20	38	$[(50'6''+51'')/2 \times (35'+33'6'')/2]$	1738.00	1	1738.00
21	39	$[(51'+51'6'')/2 \times 30']$	1537.50	1	1537.50
22	40	$[(51'6''+51'9'')/2 \times 30']$	1548.50	1	1548.50
23	41	$[(51'9''+52'')/2 \times (30'+30'9'')/2]$	1575.50	1	1575.50
				41	52553.50

Plots Area - 52553.50Sqft - 69.94%

Road Area -22587.50Sqft - 30.06%

Area Statement

6980.77Sqmt / 75141.00Sqft

Acres=1, Guntas=29.00

SEASON
Oct 2024

SCALE
1:1000 OR 1CM=10.0m, CONTOUR INTERVALS 0.5m

DRAWN BY;
Chandrashekar K.P

CONSULTANTS:

CS ENGINEERING CONSULTANTS
(Engineers and surveyors)

No:461, 15th 'D' Cross, 2nd stage,
II phase, west of chord road,
Mahalakshimpuram, Bangalore-560086.
Ph:+91-9448294223,9886042040,080-23499095.
E-mail: csengineeringconsultants@gmail.com